



THE CORPORATION OF THE TOWNSHIP OF ADJALA-TOSORONTIO

**NOTICE OF REFUSAL
OFFICIAL PLAN AND ZONING BY-LAW AMENDMENT**

**Part of Lot 30, Concession 5
4632 County Road 50
Geographic Township of Adjala
Township of Adjala-Tosorontio**

TAKE NOTICE that at its regular meeting of **August 9th, 2023**, the Council of the Corporation of the Township of Adjala-Tosorontio refused to amend the Official Plan and Zoning By-law 03-57.

AND TAKE NOTICE that the person requesting the amendment, the County of Simcoe or the Minister may appeal the refusal to the Ontario Municipal Board by filing with the Clerk of the Corporation of the Township of Adjala-Tosorontio, not later than the

30th DAY OF AUGUST 2023

a Notice of Appeal setting out the objection to the refusal to amend the Official Plan and Zoning By-law and the reasons in support of the objection, to be accompanied by the required fee to the Ontario Land Tribunal (\$1,100.00 cheque or money order payable to the Minister of Finance).

A map, showing the location of the lands to which the applications apply, is attached with this notice.

The purpose and effect of the proposed Official Plan and Zoning By-law amendment would be to permit the construction of a manufacturing and fabricating farm related industrial facility within the Agricultural (A) zone.

The decision of the Council of the Township of Adjala-Tosorontio is final if a notice of appeal is not received on or before the last day for filing a notice of appeal.

For further information, please contact the Municipal Office during regular office hours.

DATED at the Township of Adjala-Tosorontio this 10th of August, 2023.

Jaclyn Cook, Planning Technician
Township of Adjala-Tosorontio,
7855 Sideroad 30, RR #1
Alliston, Ontario, L9R 1V1

Telephone: (705) 434-5055
Fax: (705) 434-5051

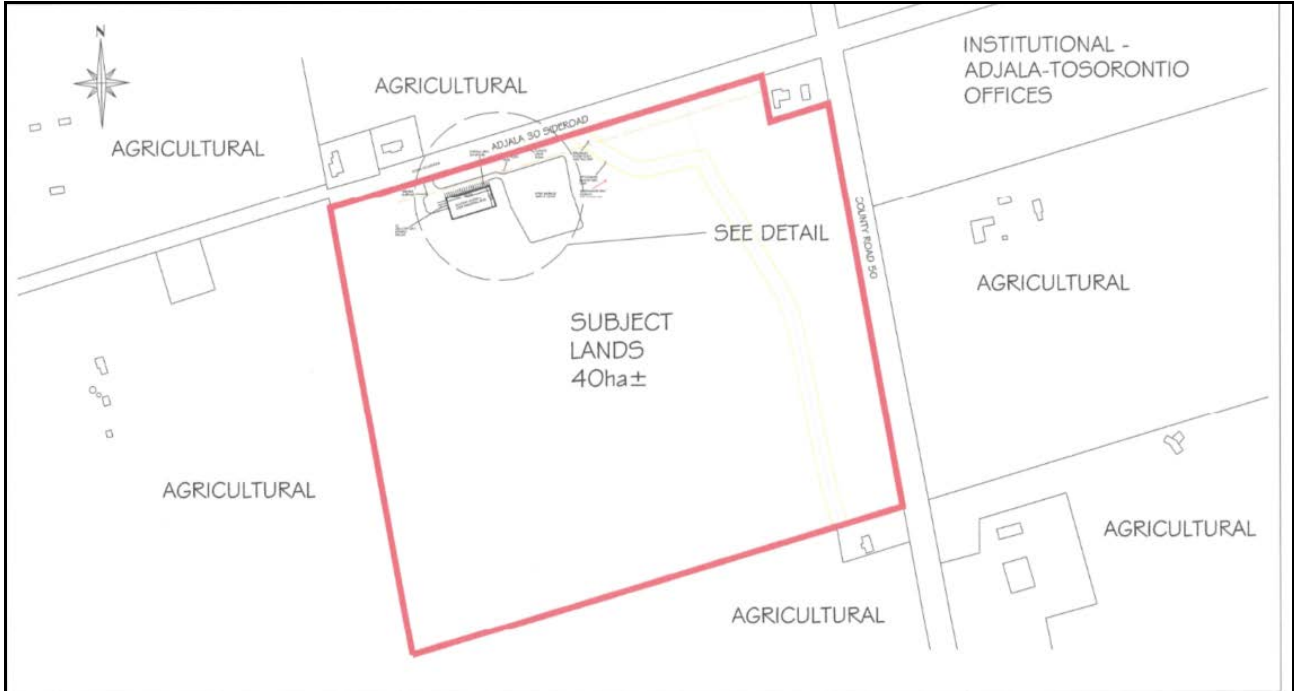

PROJECT: SITE PLAN OVERALL	LEGAL DESCRIPTION: PART OF LOT 30, CONCESSION 5 FORMER TOWNSHIP OF ADJALA TOWNSHIP OF ADJALA-TOSORONTIO COUNTY OF SIMCOE ROLL No. 4301 010 003 04900	DATE: MARCH 17, 2020
CLIENT: VINCE GAGLIARDI	LOCATION: 4632 COUNTY ROAD 50, ADJALA-TOSORONTIO	SCALE: 1:750 METRIC
		REVISION No.1: ISSUED FOR DISCUSSION
		FILE NAME: ADJALASITEPLAN.dwg