

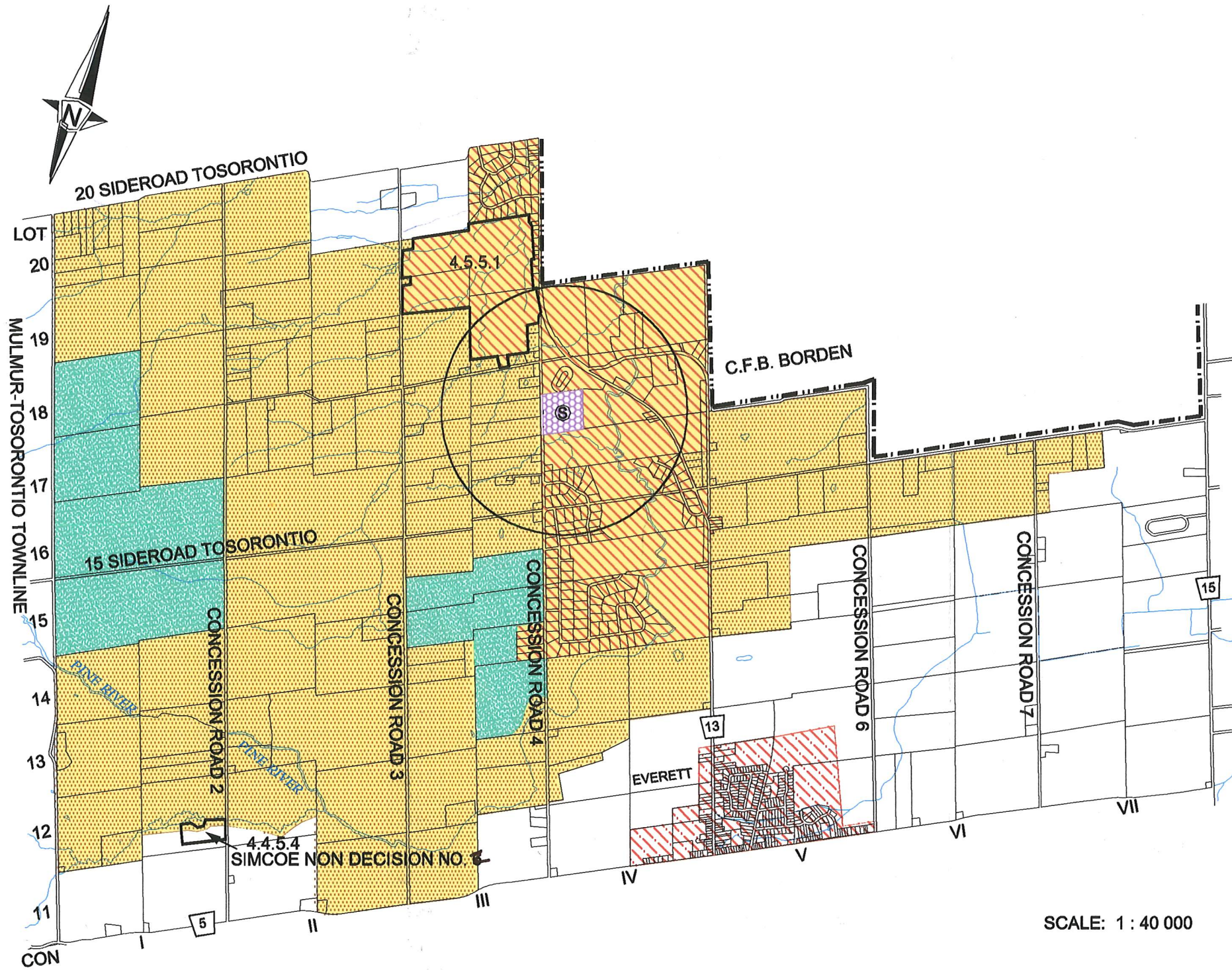

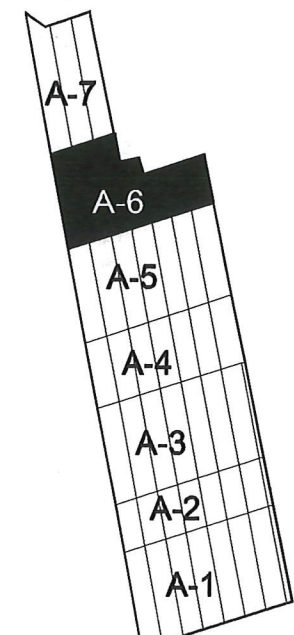











TOWNSHIP OF ADJALA-TOSORONTIO
 OFFICIAL PLAN
 Schedule A-6
 LAND USE



SCALE: 1 : 40 000

LEGEND

-  OAK RIDGES MORaine
(Approximate North Limit)
-  ENVIRONMENTAL PROTECTION AREA
-  CANADIAN FORCES BASE BORDEN
(Federal Lands)
-  AGRICULTURAL
-  RURAL
-  RURAL RESIDENTIAL
-  HAMLETS
(See Schedule B1 to B7 for land use details)
-  PROTECTED AGGREGATE RESOURCE
-  LICENSED PIT
-  OPEN SPACE - RECREATION
-  SPECIAL POLICY AREAS
-  LICENCED WASTE DISPOSAL AREA
(County of Simcoe - S / Closed - C)
1000 metre setback for landfill site denoted by circle
-  SUBJECT TO SPECIAL PROVISIONS 4.4.5.4
(Simcoe Non Decision No. 6)
-  SUBJECT TO SPECIAL PROVISIONS 4.5.5.1

Prepared By:
WALTON & HUNTER Planning Associates
 Bracebridge, Ont.
 Nov. 2, 1998, with revisions to Oct. 28, 1999
 Consolidated to November, 2000