

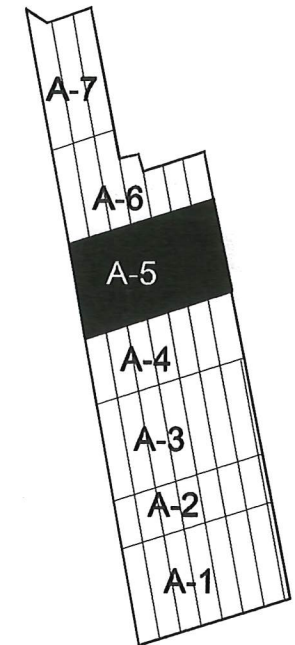

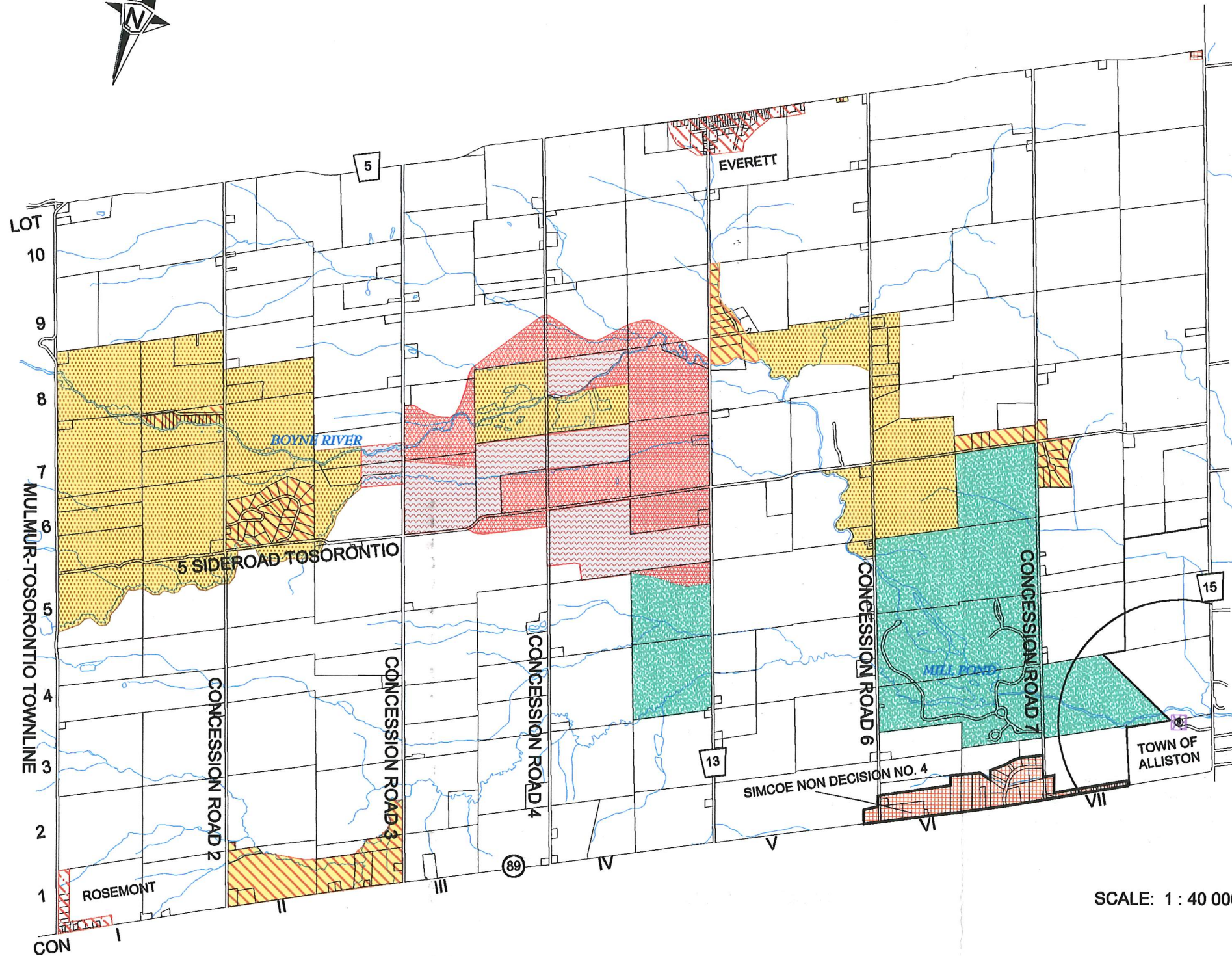











**TOWNSHIP OF ADJALA-TOSORONTIO  
OFFICIAL PLAN  
Schedule A-5  
LAND USE**



**LEGEND**

-  OAK RIDGES MORaine (Approximate North Limit)
-  ENVIRONMENTAL PROTECTION AREA
-  CANADIAN FORCES BASE BORDEN (Federal Lands)
-  AGRICULTURAL
-  RURAL
-  RURAL RESIDENTIAL
-  HAMLETS (See Schedule B1 to B7 for land use details)
-  PROTECTED AGGREGATE RESOURCE
-  LICENSED PIT
-  OPEN SPACE - RECREATION
-  SPECIAL POLICY AREAS
-  LICENCED WASTE DISPOSAL AREA (County of Simcoe - S / Closed - C) 1000 metre setback for landfill site denoted by circle

Prepared By:  
**WALTON & HUNTER** Planning Associates  
Bracebridge, Ont.  
Nov. 2, 1998, with revisions to Oct. 28, 1999  
Consolidated to November, 2000